



## LEAH ATKINSON - DESIGN PORTFOLIO

Selected Works | Architecture | Product Design | Illustration

CONTACT [07873679854](tel:07873679854) | [leah.atkinson05@icloud.com](mailto:leah.atkinson05@icloud.com)

LINKEDIN [www.linkedin.com/in/leahatkinson05](http://www.linkedin.com/in/leahatkinson05)

CREATIVE DOCUMENTATION [instagram.com/leahatkinsonarts](https://www.instagram.com/leahatkinsonarts)

# FINAL ARCHITECTURE PROJECT ‘The Canopies of the City’

- Fine Arts University Campus



Desired usage illustrations - setting the scene



Concept development - from studying the autumn leaf, to creating forms



## CONCEPT

Inspired by the movement and structure of falling autumn leaves and urban tree canopies, this project explores how lightweight architectural forms can create sheltered public space within the city.

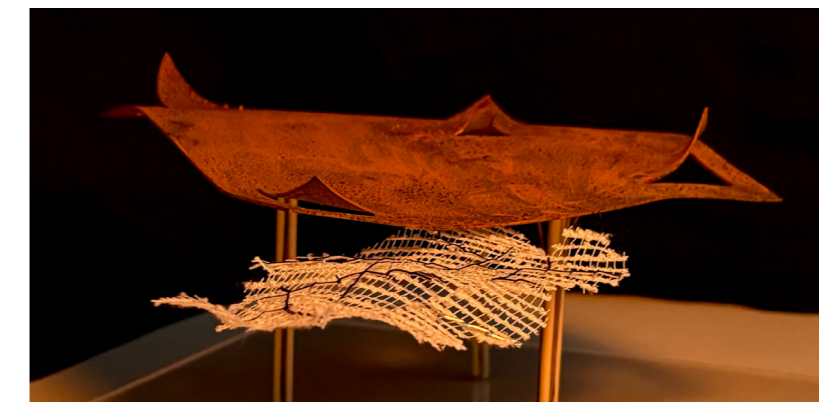
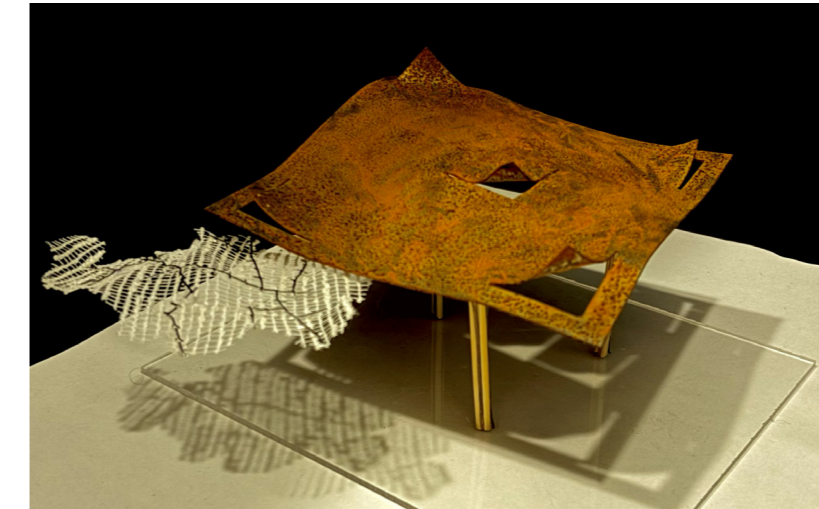

Concept model - rustic / peeling / canopy

Programme model of the proposed ‘canopies of the city’ fine arts campus



## DESIGN FEATURES

- Organic layered canopy structures
- Corten steel provides warm rusted tones reflect the colours of autumn foliage, blending with the surrounding trees.
- The material’s natural patina develops over time, reinforcing the project’s connection to seasonal change and the natural landscape.
- ‘Peeled’ back skylights, reflecting the curl and cracks in an autumn leaf.

# FINAL ARCHITECTURE PROJECT ‘The Canopies of the City’

- Fine Arts University Campus

The atmosphere of the fine arts university is shaped by creativity, collaboration, and connection. Flexible studio spaces support both individual work and group discussion, while a perforated Corten steel screen subtly defines zones without restricting openness.

A central atrium organises circulation through a branching arrangement inspired by “the canopies of the city,” visually connecting multiple levels. Varying building heights reflect surrounding tree canopies, while a continuous wrapping balcony blurs the boundary between interior and exterior. Together, these elements create a nature-inspired environment that encourages creative exploration and exchange.

Part plan & section CAD drawing



Part model



Section illustration

SECTION B



Sketchup model elevation



Serial visions - a journey through campus

# ARCHITECTURE PROJECT

## 'The Peace Pavilion'

### CONCEPT

A woodland pavilion designed to promote relaxation, mindfulness and community activity within the natural setting of Holes Bay.

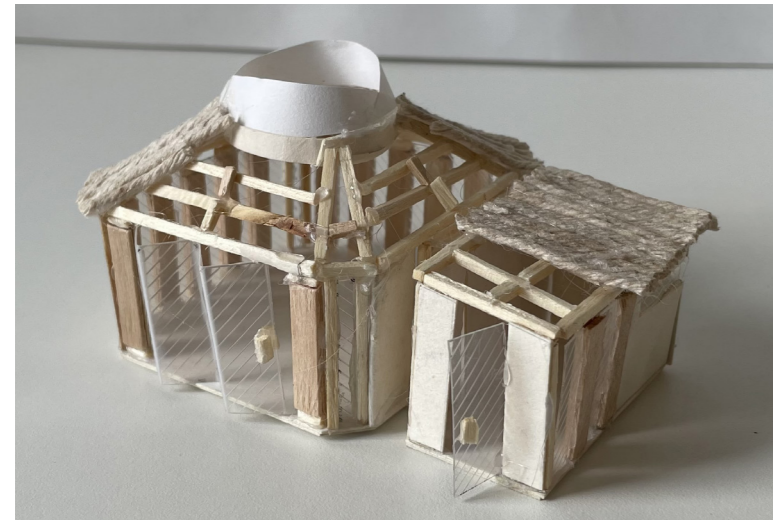

Concept model development, with structural consideration

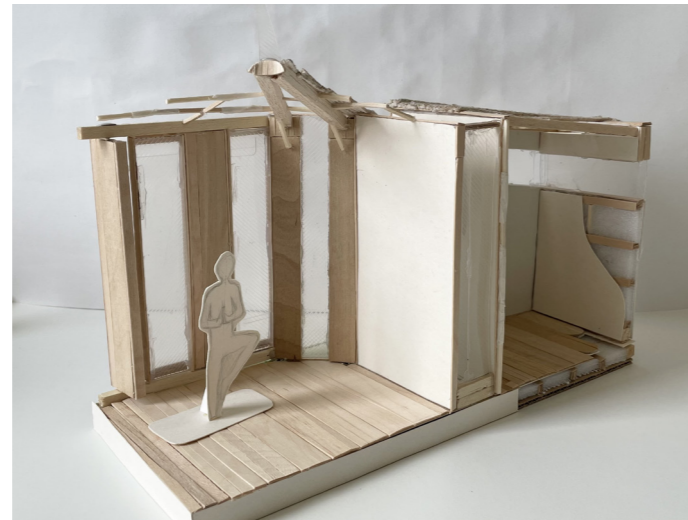

Door handle concept derived from near by lake ripples

### Internal usage illustrations

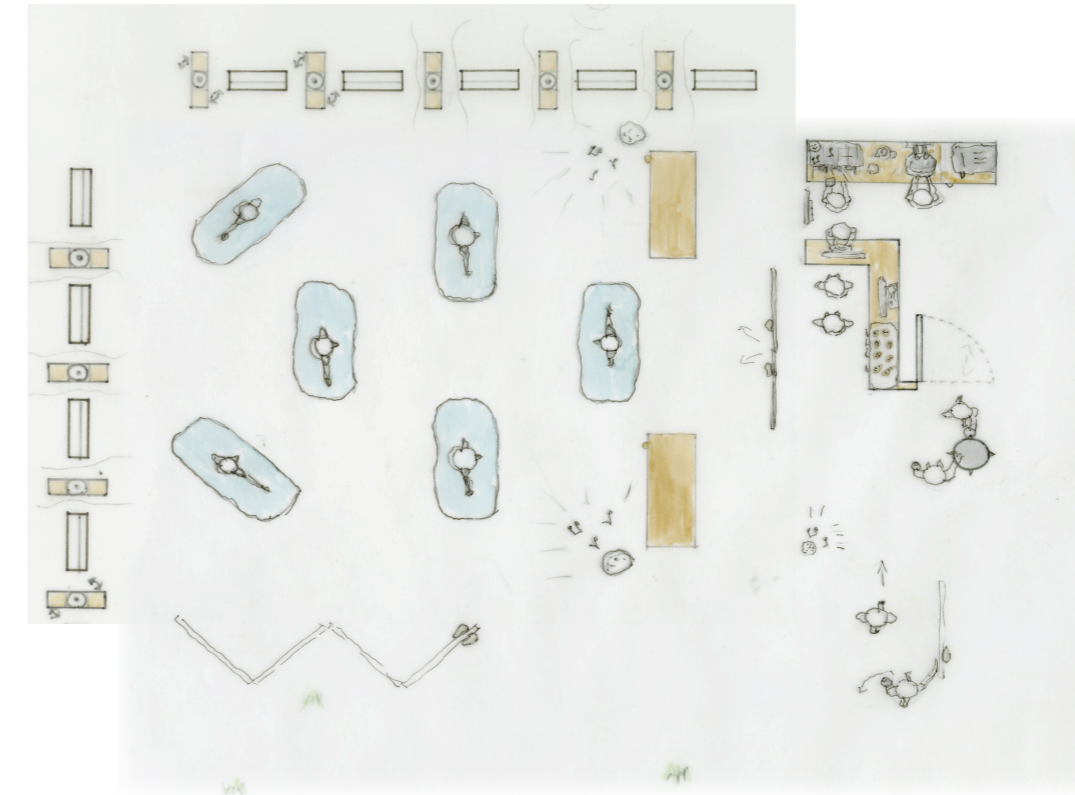

Plan view showing yoga/cafe usage, with demonstration of opening beams

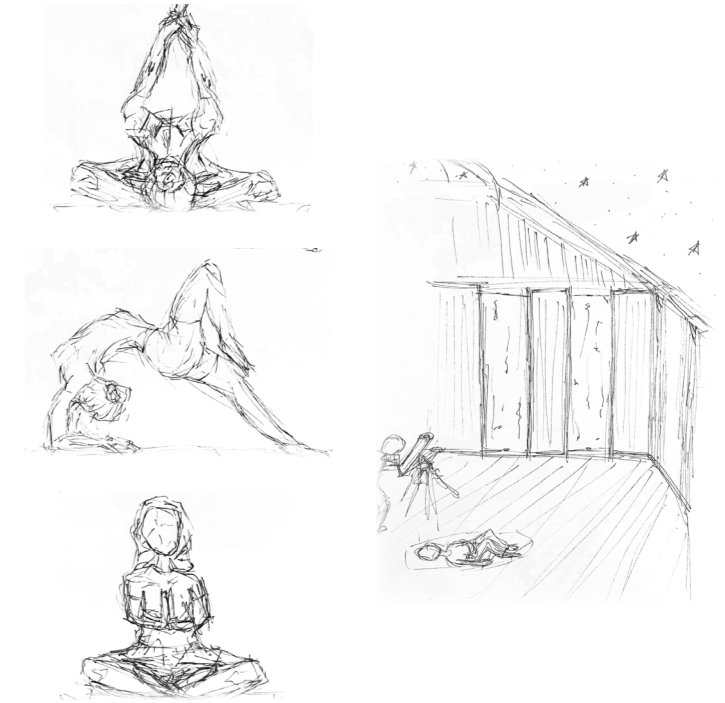

### DESIGN FEATURES

- Twisting glulam timber structure inspired by organic growth patterns
  - Adjustable beams allow natural ventilation and light control
- Open pavilion layout supporting yoga, workshops and gatherings
  - Dome structure designed for night-time stargazing

# ARCHITECTURE PROJECT ‘The Urban Art Blocks’

## CONCEPT

A rammed earth art block, positioned aligning the trees, where they are emerged into the nature to provoke creativity and improved education.



Concept model

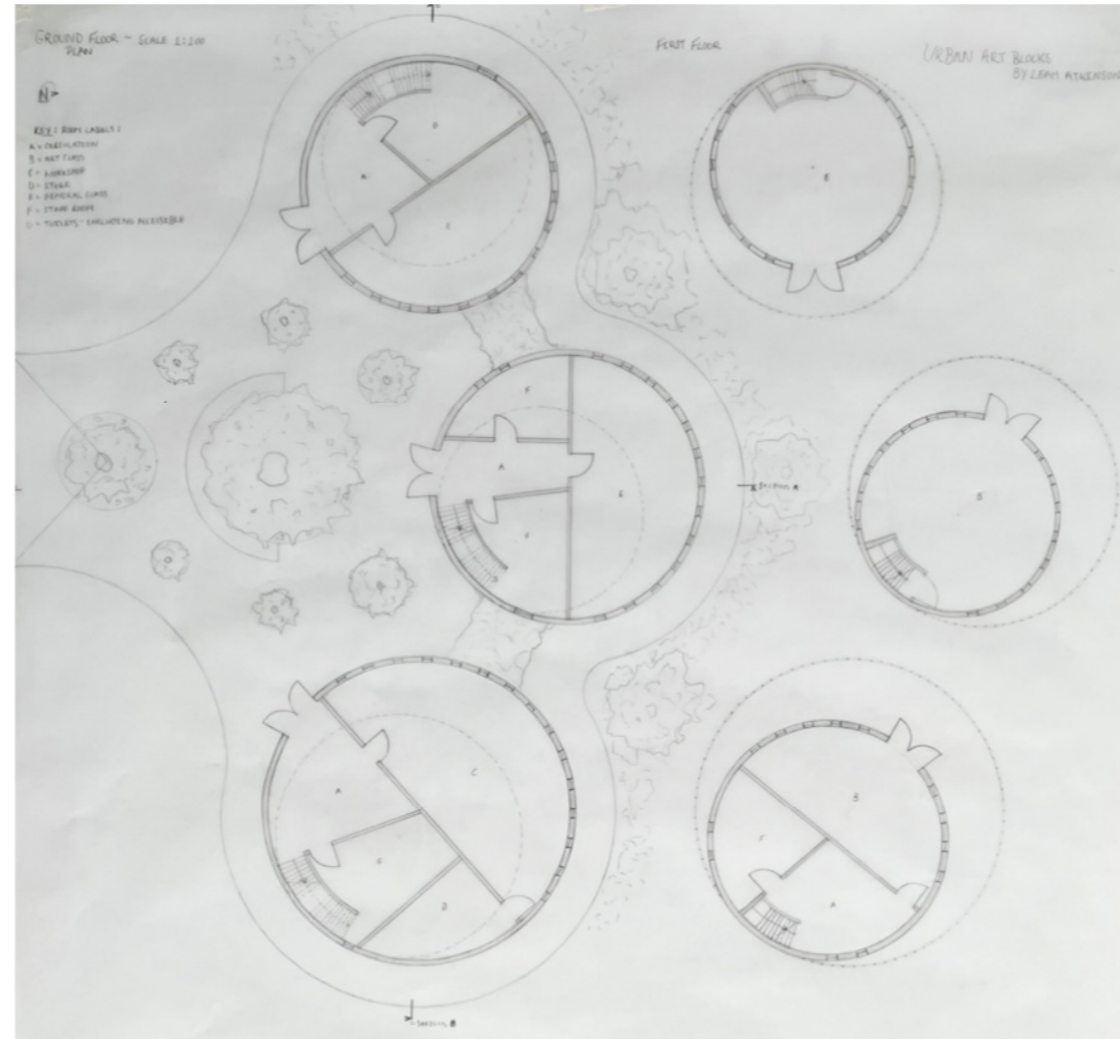

Plan drawings

Side section drawing



Front elevation drawing

## DESIGN FEATURES

- Circular rammed earth blocks, varying in size, aiming to encourage learning/creating together, without any corners to hide.
- Ramped walkway around the blocks for nature emergence and passageways between blocks.
- Classroom terraces for outdoor activities.

# ARCHITECTURE PROJECT

## Precedent Studies

Fuji Kindergarten - Tokyo - Tezuka Architects

This precedent study explored how architectural design can encourage creativity, movement and interaction in educational environments.

Key observations:

- Circular building form encourages movement and play
- Integration of existing trees connects children with nature
- Open classroom layout promotes collaboration and sensory stimulation
- Flexible sliding screens blur boundaries between interior and exterior

Internal sketch

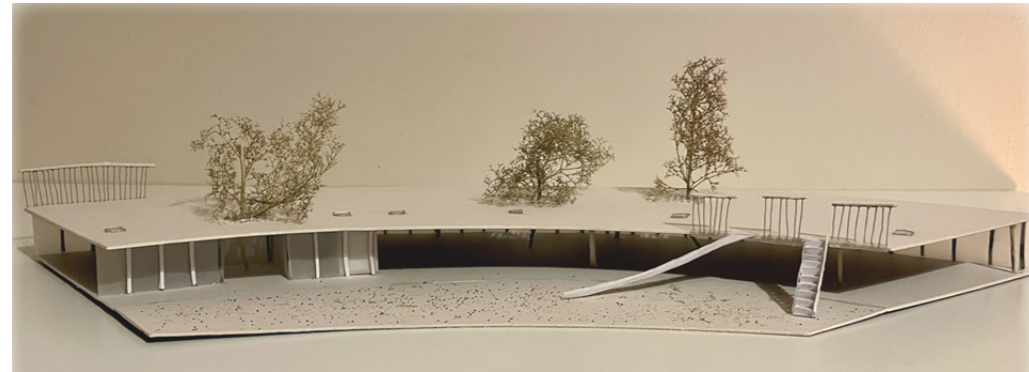

Part model

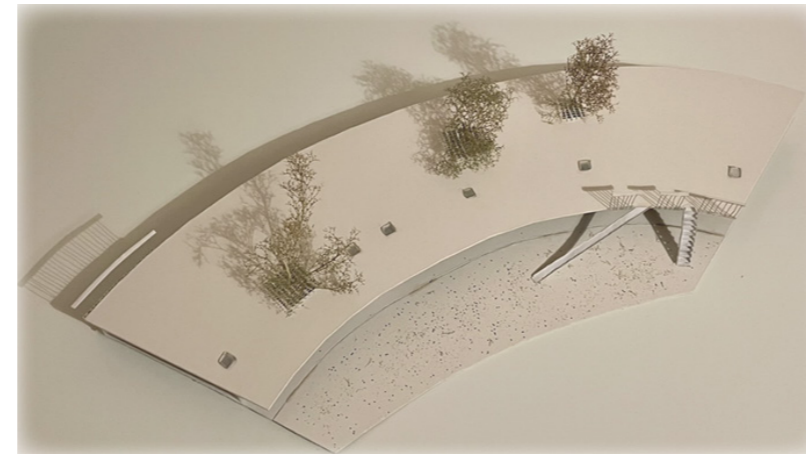

Front elevation & Part wall section



Jeanne d'Arc Nursery - France

This precedent study examined how contemporary nursery architecture can create stimulating learning environments while maintaining safety and comfort for young children.

Focus areas included:

- Spatial organisation and circulation
- Use of natural light and outdoor space
- Child-centred scale and materials

Drawings and models were produced in both studies to analyse spatial organisation, circulation and environmental design strategies.

# PRODUCT DESIGN PROJECT

## 'The Commute Bag'

### CONCEPT

A commuter bag designed for people who work while travelling, providing a portable workspace that can be used when seated or standing.

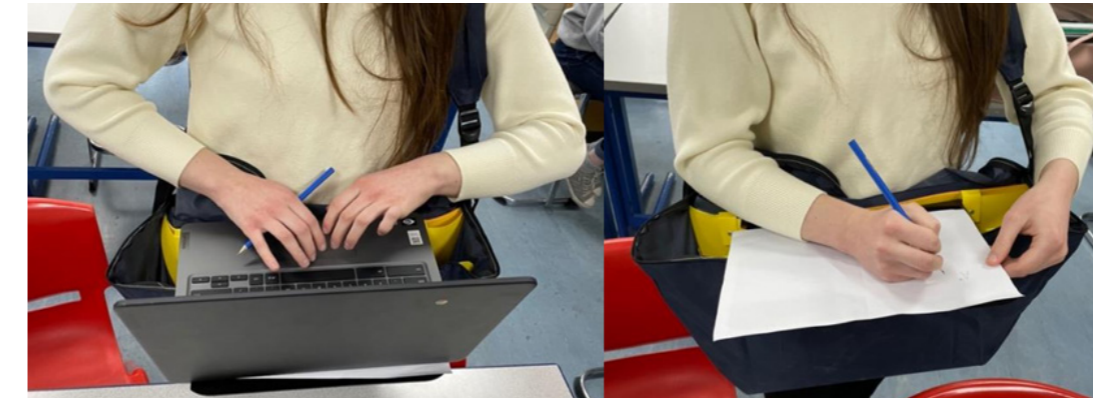

### DESIGN FEATURES

- Integrated pull-out mini desk for laptop or tablet use
- Designed to be worn front or side-facing for accessibility
- Allows commuters to work comfortably in crowded spaces
- Compact form maintaining everyday practicality

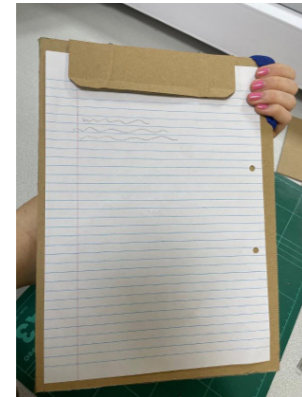

Design process



Bag pattern production



Final model

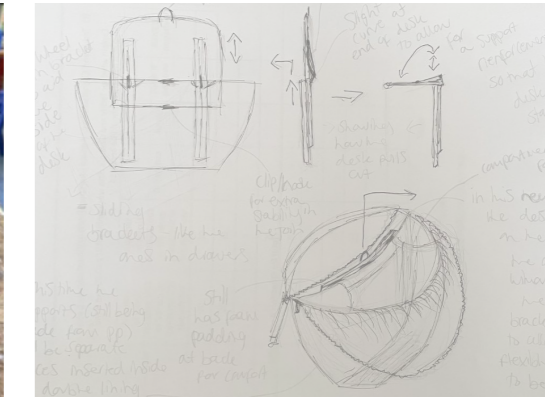

\*Google Image displaying current issue

## OBSERVATIONAL ARTWORK

A collection of personal drawings and paintings exploring light, texture and form.

These works support my design practice by strengthening visual observation, composition and material understanding.

Media - Watercolour | Pencil | Ink



Silly cartoons  
- Fine liner



Shocked old man  
- Pencil



Abstract tiger  
- Watercolour



Sketch of my own hand  
- Pencil



Depiction of urban decay  
- Mixed media



Boat house  
- Watercolour

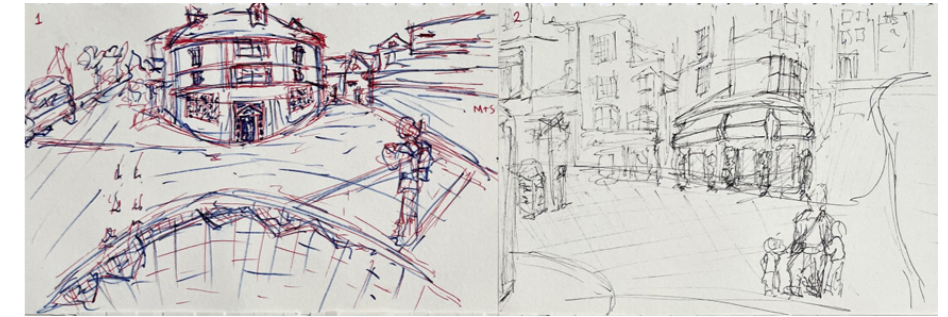

Street observation  
- Pen

## OBSERVATIONAL ARTWORK

A collection of personal drawings exploring light, texture and form.

These works support my design practice by strengthening visual observation, composition and material understanding.

Media - Pencil | Ink



Leopards roar  
- Pencil



Winter birdy  
- Pencil



Dark swan  
- Pencil



Vase of flowers  
- Pencil



Silenced  
- Fine liner



Silly cow  
- Fine liner



Silly cartoons pt.2  
- Fine liner



Silly cartoons pt.3  
- Fine liner